

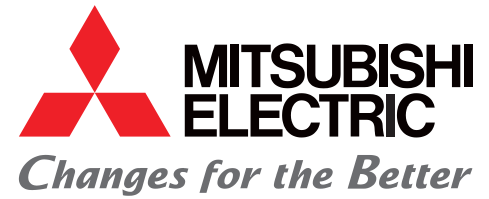

for a greener tomorrow



FR-E700SC SERIES MICRO-DRIVE

Product Overview

**5 YEAR
WARRANTY**



The FR-E700SC VFD offers the motor performance usually associated with high power sensorless vector control motor drives into a compact drive package.

KEY BENEFITS:

- **5 year warranty** – For extra peace of mind
- **Safety drive capability** – Eliminate the need for an extra contactor for operator safety
- **Built-in Modbus® RTU communications** – Seamless integration into control systems
- **120:1 speed range** – Fast acceleration and excellent motor starting torque for heavy loads
- **Auto-tuning capability** – Maximize the performance of 3rd party motors quickly and easily
- **Integral USB port** – Allows quick and simple set-up from a PC
- **Built-in dynamic braking circuit** – Allows for simple installation of brake resistors for heavy deceleration
- **Multiple communication options** – Communicate with the drive over a wide range of fieldbus or Ethernet networks

MODBUS® is a registered trademark of the MODBUS-IDA Organization.



FR-E700SC Series Micro-drive – Product Overview

5 YEAR WARRANTY

Mitsubishi Electric's famous 5 year micro-drive warranty is our expression of confidence in the quality and durability of FR-E700 – and your peace of mind.

FAST SET-UP

The built-in USB port in the FR-E700 Series drives enables fast and simple programming and diagnostics via FR CONFIGURATOR software. Set all drive parameters without powering up the drive using the FR-PU07BB battery powered parameter keypad.

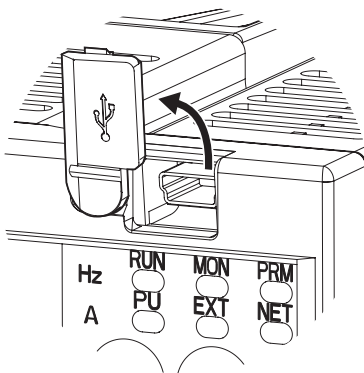

EASY INTEGRATION

FR-E700 is compatible with a host of option cards, allowing it to be integrated into complex systems. Communication over factory fieldbus or Ethernet networks is a breeze.

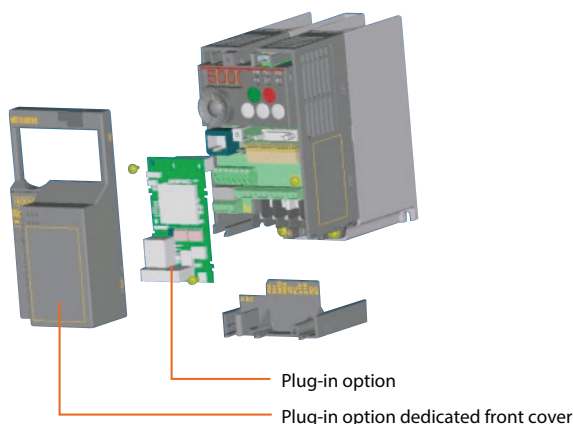

SAFETY DRIVE

A special redundant circuit in FR-E700 allows the elimination of a dedicated emergency stop contactor, reducing installation cost and installation space.

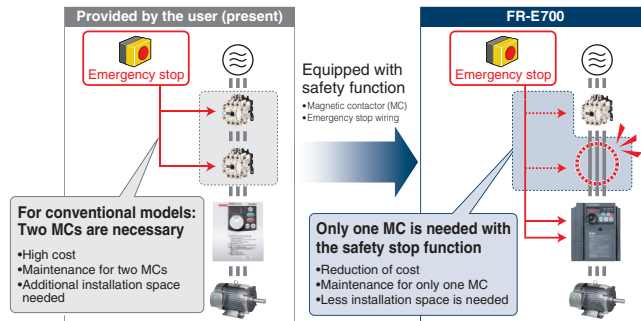

BOOKSHELF MOUNTING

FR-E700 can be installed in a cabinet 'bookshelf style', reducing total installation space inside the control panel.



MITSUBISHI ELECTRIC AUTOMATION, INC.

500 Corporate Woods Parkway, Vernon Hills, IL 60061
Ph 847.478.2100 • Fx 847.478.2253

us.MitsubishiElectric.com/fa/en

June, 2016 • ©2016, Mitsubishi Electric Automation, Inc. •
Specifications subject to change without notice. • All rights reserved

L-VH-04082
F72-155-SLSMKTG-004-*