

## Mitsubishi Graphic Operation Terminal GOT SIMPLE Series Solution Catalog

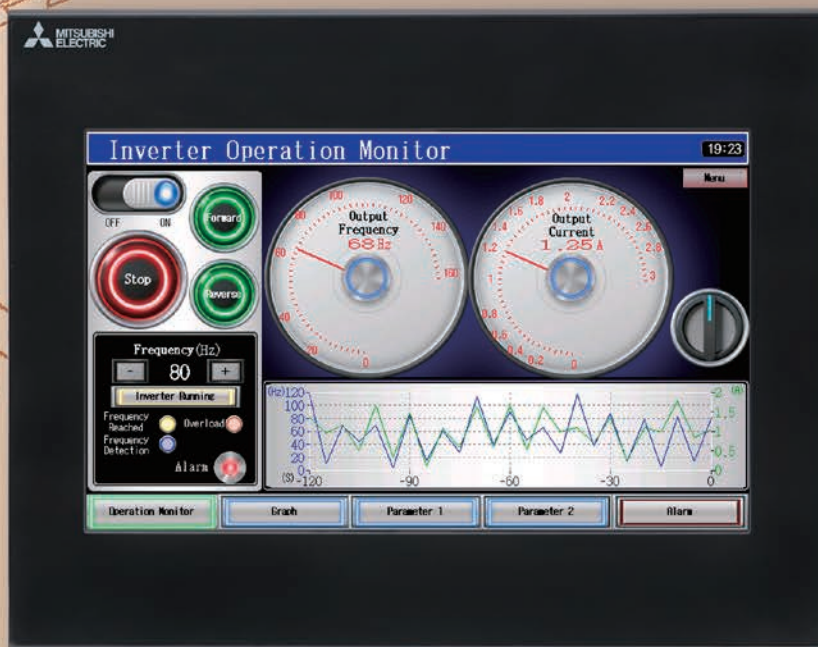

*Simple Solutions*

# GOT SIMPLE

Graphic Operation Terminal

# Mitsubishi Industrial Devices Simple Solution

Using Mitsubishi Electric industrial devices together with the GOT SIMPLE Series provides ideal, simple solutions that enhance efficiency and reduce cost in production.

Using GOTs with other devices makes your production process smoother than ever

01

## Material handling

INVERTER

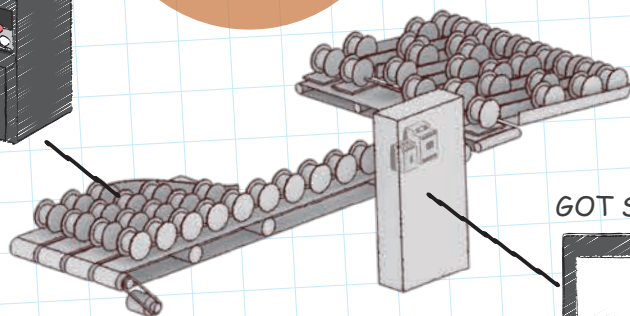
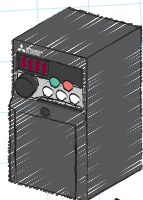

GOT SIMPLE

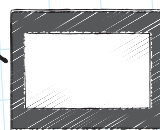

02

## Machining

SERVO Amp.

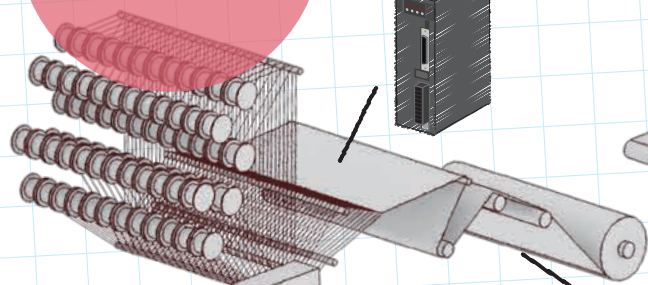
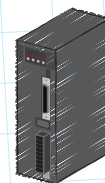

Micro PLC

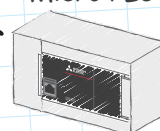

GOT SIMPLE

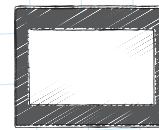

### Simple control

General-purpose inverter



GOT SIMPLE



Visualization, plus!

### Positioning control

Programmable controller



AC servo



GOT SIMPLE



Visualization, plus!



03

Packing

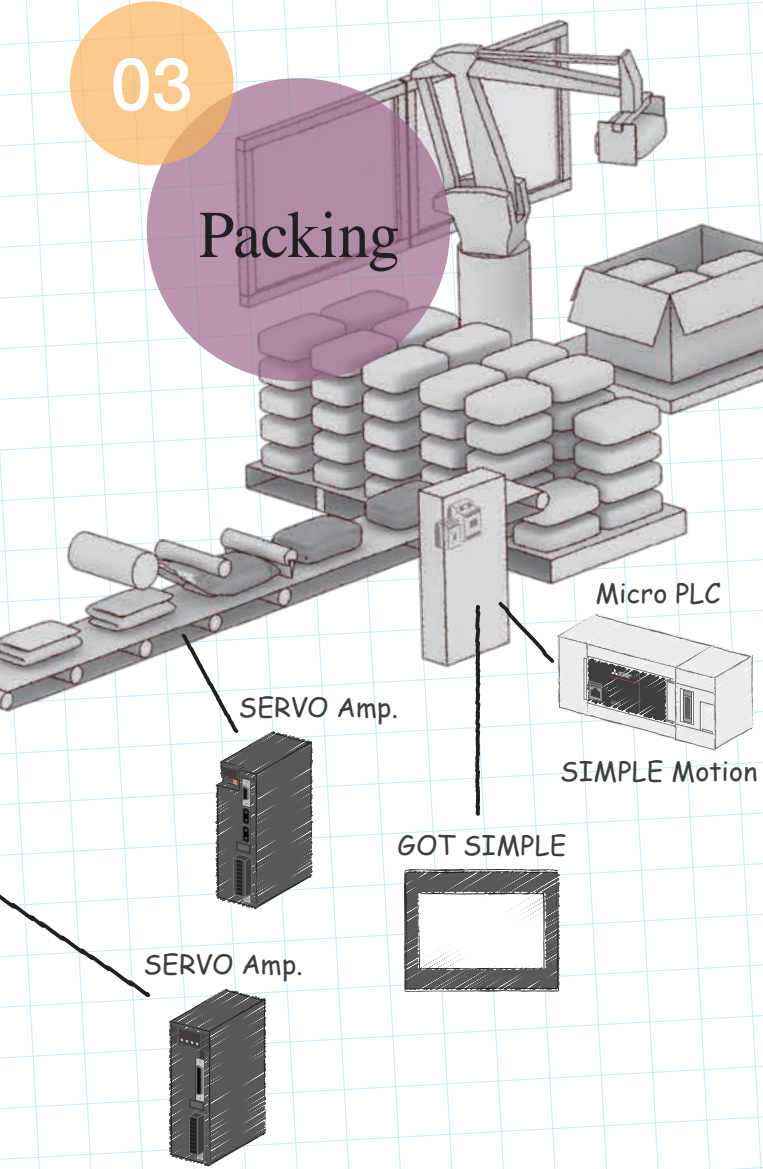

Plus

Advanced automation

ROBOT

## Simple Solutions

- 01 Material handling Easy material handling with inverters .....04
- 02 Machining Easy textile processing with programmable controllers and servos .....06
- 03 Packing Easy packing with simple motions and servos .....08

Smooth drive control

Programmable controller Simple motion

AC servo

GOT SIMPLE

Visualization, plus!

Mitsubishi Graphic Operation Terminal	
GOT SIMPLE	.....10
Mitsubishi Inverter FR-D700	.....11
Mitsubishi Programmable Controller MELSEC iQ-F	.....12
Mitsubishi AC Servo MELSERVO-JE	.....13
Mitsubishi Industrial Robot MELFA	.....14
Mitsubishi Magnetic Contactor	.....14
Engineering Software	.....15

01

# Material handling

Simple settings  
Low cost

# Easy material handling

The “non-rotation” auto tuning function optimally controls

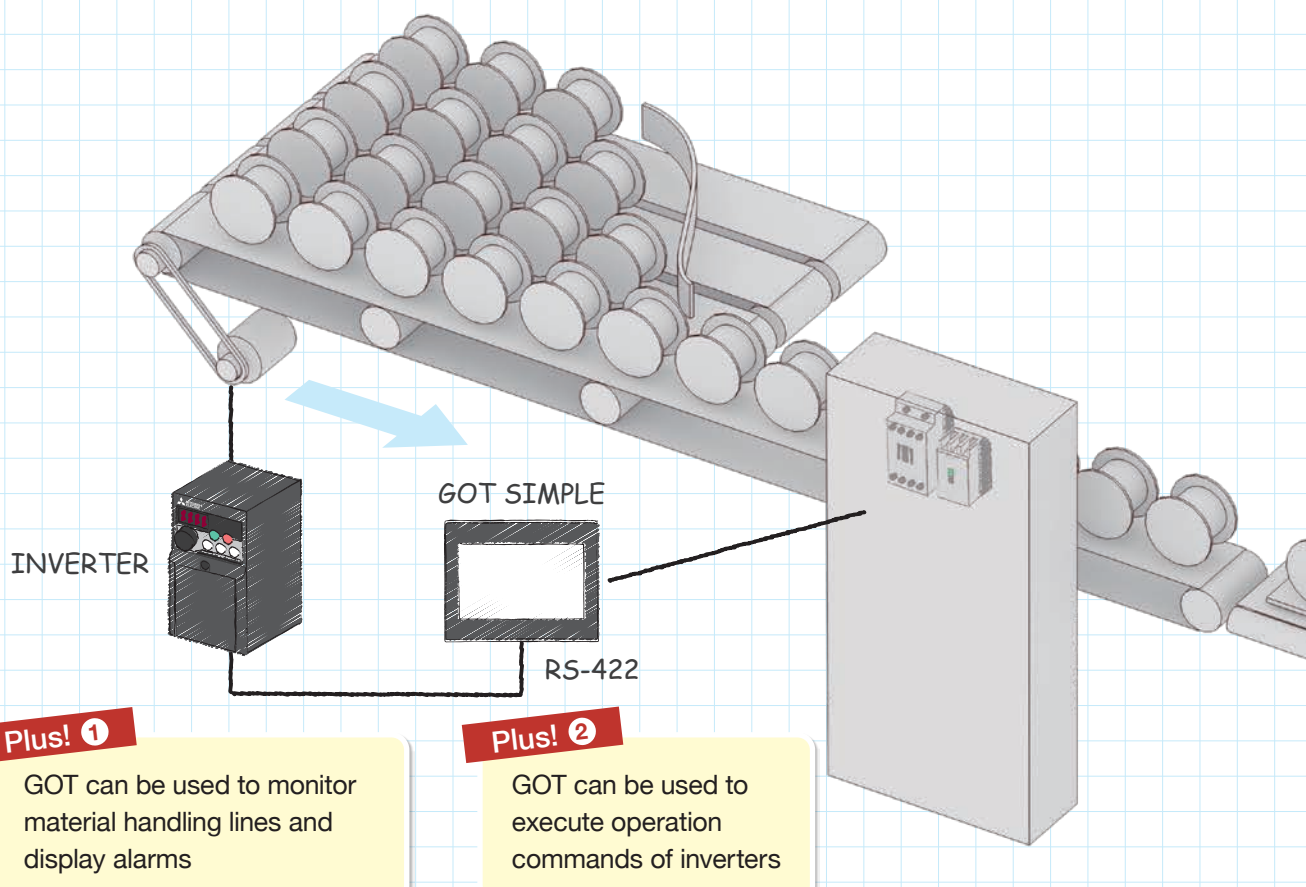

Mitsubishi Inverter

FR-D700



Many kinds of motors can be optimally controlled with Mitsubishi original “non-rotation” auto tuning function. Inverter output current may be used to assume motor slip to keep the motor speed constant.



Mitsubishi  
Graphic Operation Terminal

GOT SIMPLE



Visualization, plus!

# ing with inverters

motors.

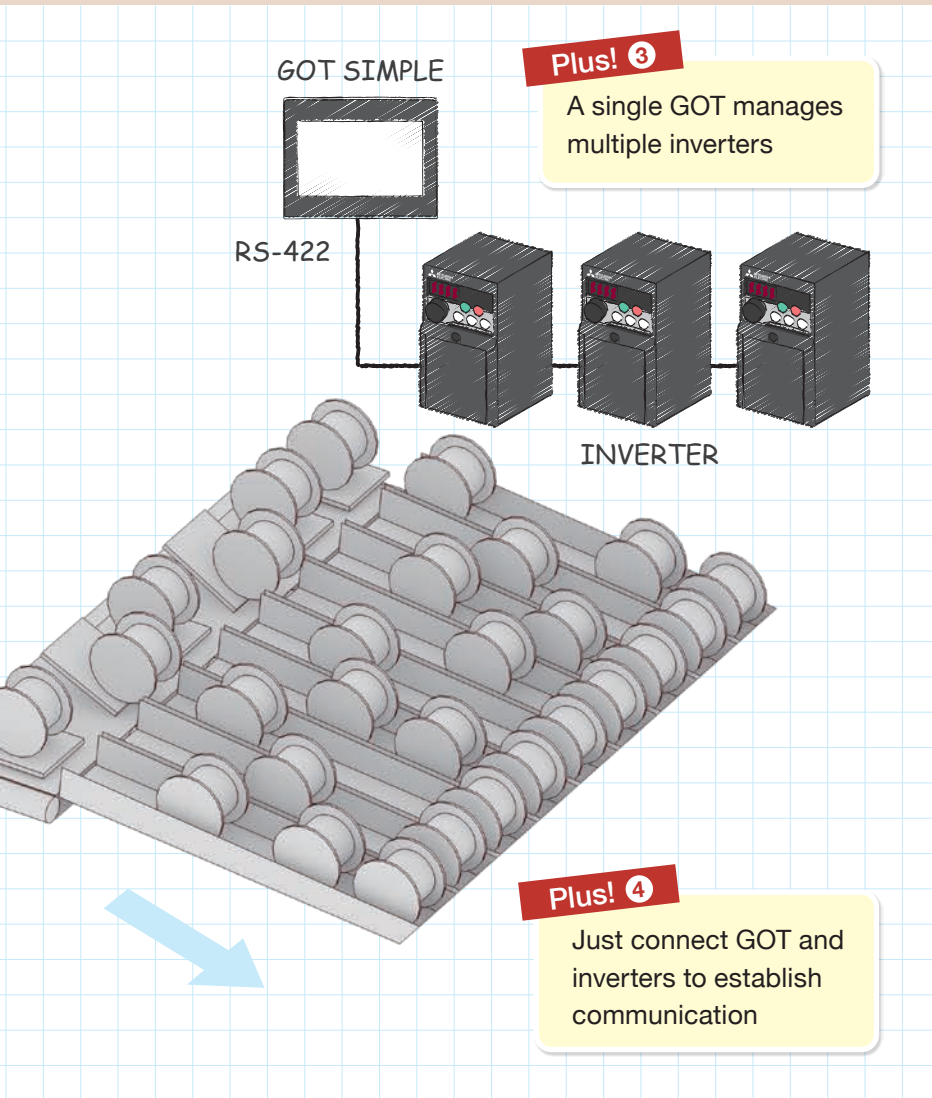

## Application examples



Material handling in a logistics center



Baggage handling in an airport

## Simple Solutions

- Packaged benefits -

Easily collect and display data of industrial devices

### ■ Logging function

GOT manages the data of all connected industrial devices. The data can be collected at an arbitrary timing and can be used for data analysis and feedback.



General-purpose inverter



GOT SIMPLE

### ■ Historical trend graph

The data collected by the logging function is displayed in a graph. It is easy to check by scrolling or specifying time.

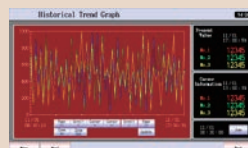

Easy startup, adjustment of industrial devices

### ■ FA transparent function

The GOT acts as a transparent gateway to enable programming, start up, and adjustment of devices.

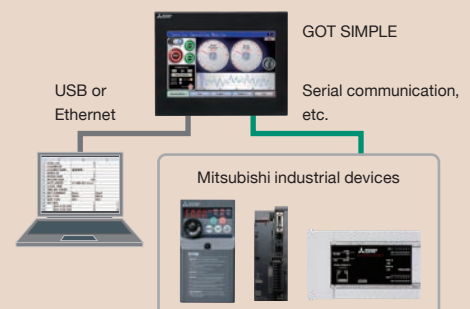



02

# Machining

High functionality  
Low cost

## Easy textile processing

The pulse I/O of programmable controllers enable advanced

### Plus! ①

Smooth operation by using interrupt, variable speed, and simple interpolation function

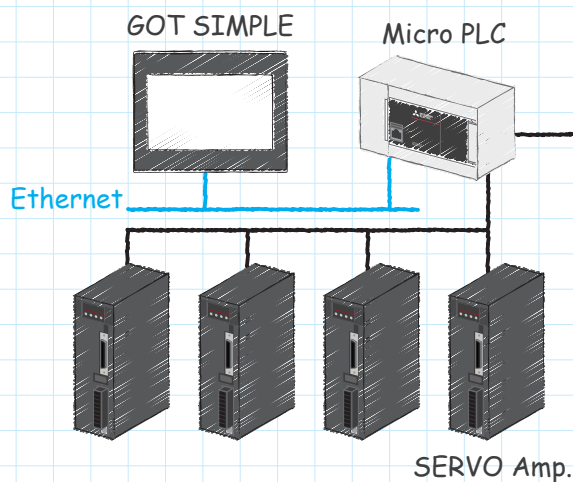

### Plus! ②

The GOT backup/restoration function quickly restores sequence programs

### Mitsubishi Programmable Controller

## MELSEC iQ-F



MELSEC iQ-F programmable controllers are equipped with high-speed I/O, and can be connected to up to 4 axes of AC servos without additional modules.



### Mitsubishi AC Servo

## MELSERVO-JE A type



Setting and making changes are easy using the table method programs so that the positioning operation can be performed in high-speed startup.

# with programmable controllers and servos

positioning and smooth operation of AC servos.

Plus! ③

Connect GOT and AC servos directly to execute positioning commands

GOT SIMPLE

RS-422

SERVO Amp.

Plus! ④

Built-in positioning function

Application examples



Food processing



Textile processing

Mitsubishi  
Graphic Operation Terminal

GOT SIMPLE



Visualization, plus!

## Simple Solutions

- Packaged benefits -

Backup of important programs

### ■ Backup/Restoration function

Using the backup/restoration function, sequence programs can be replaced even without a personal computer. When the programs and parameters are backed up to GOT\*, the data and machine operation can instantly be restored even if an unexpected failure occurs.

\*: An SD memory card is required separately.



03

## Packing

High efficiency  
Low cost

# Easy packing with

SSCNETIII/H compatible simple motion modules and with high synchronous performance and less wiring.

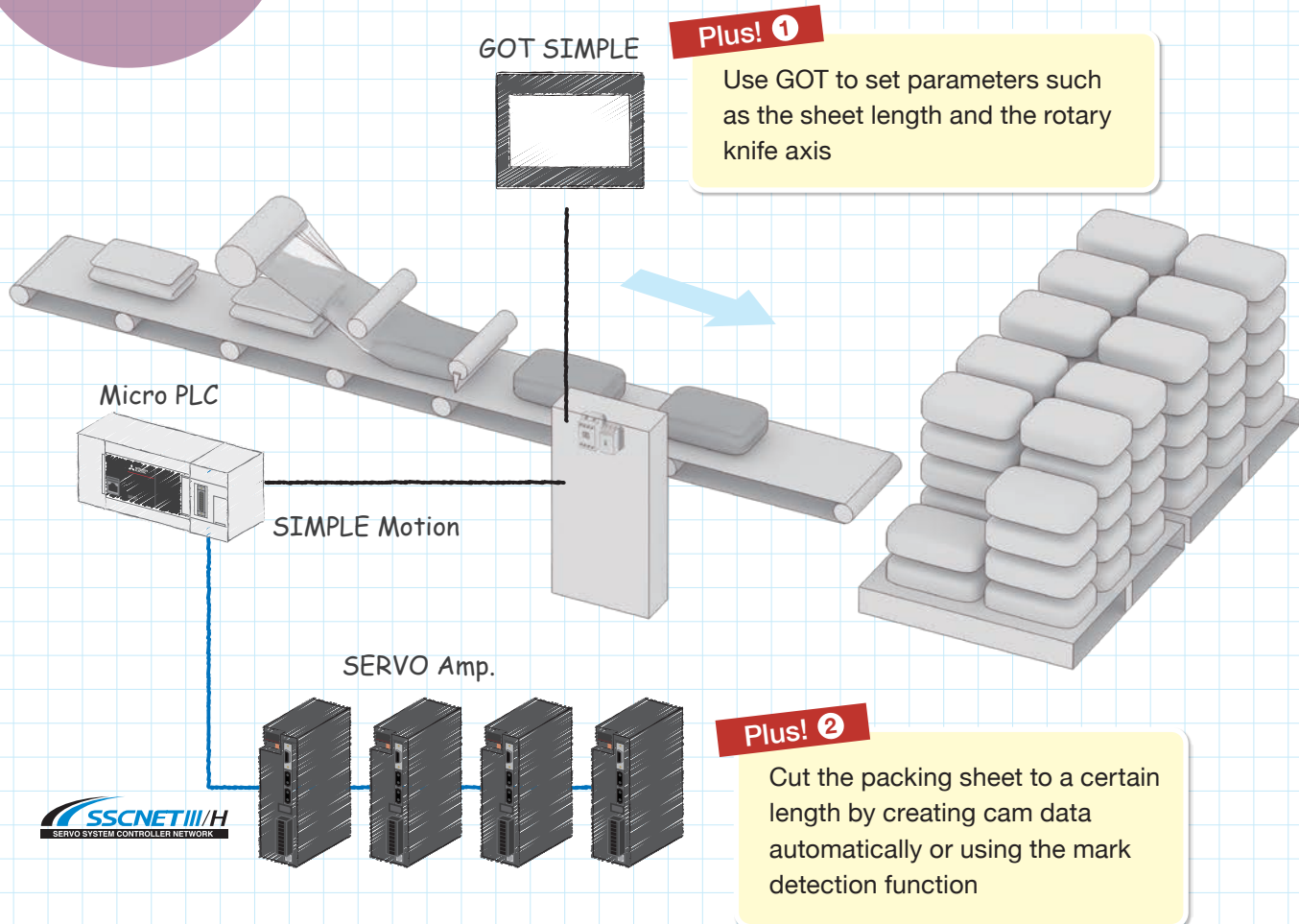

### Mitsubishi Programmable Controller

## MELSEC iQ-F



MELSEC iQ-F + Simple Motion

Easily program and automatically generate difficult cam data for rotary cutters just by inputting the sheet length, synchronization width, and cam resolution, etc.



### Mitsubishi AC Servo

## MELSERVO-JE B type



When the machine packs products, the whole process is synchronized by using synchronous control and cam control.



# simple motion and servos

servo amplifiers enable a high-response system

Plus

## Advanced automation

PLC



GOT2000

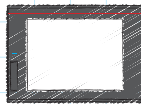

ROBOT

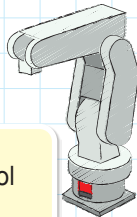

Plus! ③

Robot CPUs enable high-speed control by directly connecting programmable controllers and robots

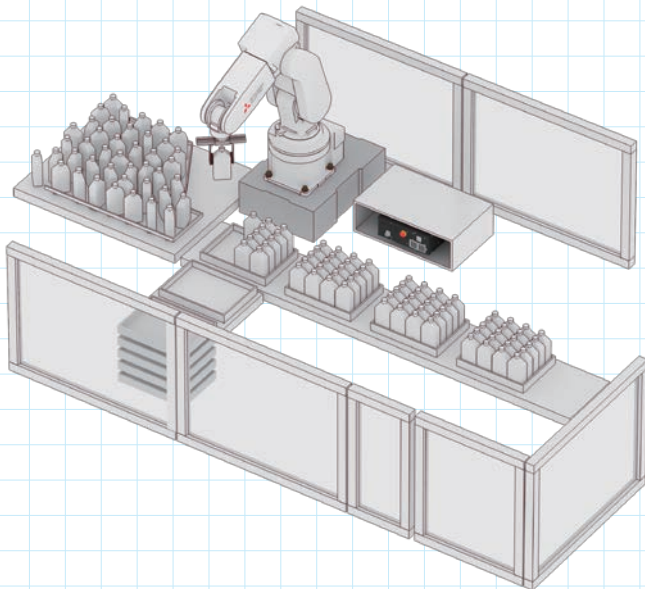

### iQ Platform compatible products + CC-Link IE

## iQ Platform compatible robots

Robots can be controlled using programmable controllers and GOTs by connecting them directly to each other. Seamless connectivity within all levels from the sensor to the server, visualization of data, and less wiring of various networks can be achieved.

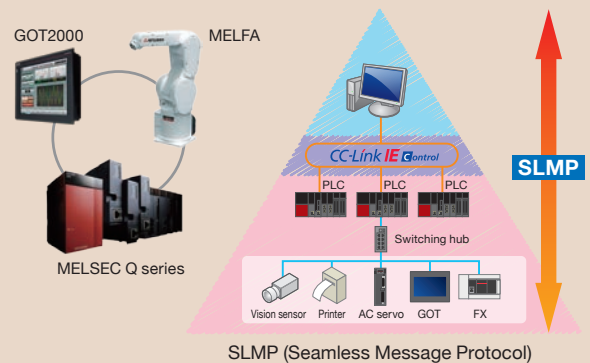

### Mitsubishi safety solutions

Safety relay



Safety programmable controller



Safety controller

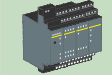

A wide variety of safety product lineup provides total safety solutions

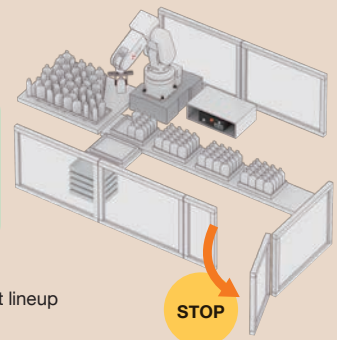

Mitsubishi  
Graphic Operation Terminal

## GOT SIMPLE



Visualization, plus!

## Simple Solutions

- Packaged benefits -

Easy monitoring of servo operation status

### Servo connection

Connecting servo amplifiers directly to GOT enables easy setup, monitoring, adjusting alarms, diagnosis, parameter settings, and test operation.

RS-232/  
RS-422  
communication  
ports

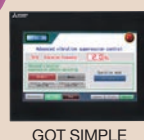

Parameter  
adjustment

Monitoring

MITSUBISHI SERVO AMPLIFIERS & MOTORS  
MELSERVO



RS-422  
communication  
Maximum  
10 units

RS-232  
communication  
Maximum  
1 unit

Simple

GOT

Simple, high functioning



## GOT SIMPLE

Graphic Operation Terminal

- Reduce design, setup, and maintenance cost
- Add value to your installation and machine
- Streamlined screen design



For the details of the GOT SIMPLE Series, please refer to the catalog on the left.  
(HIME-L076)



**GS2110-WTBD**

10 inch Touch panel HMI



**GS2107-WTBD**

7 inch Touch panel HMI

### Control multiple industrial devices

#### ■ Multi-channel function

Up to 2 channels of industrial devices can be controlled with one GOT. The data can be easily transferred between devices with just simple settings.

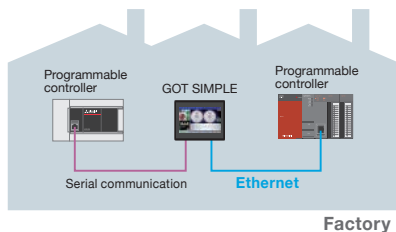

### Reduce mass production setup costs

#### ■ Start from SD memory card

Transfer the screen and all necessary system data to an SD memory card in advance. Then the GOT can be used just by inserting the SD memory card. It is easy to start up and operate the GOT.

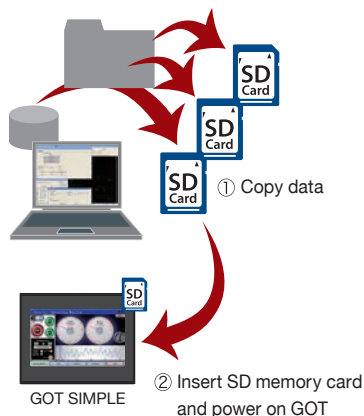

### GOT SIMPLE useful functions

#### ■ Alarm function

Alarm functions such as alarm display, alarm history, and alarm pop up display are included. The language switching function is also supported.

#### ■ Various sample screens

Sample screens are available to monitor and change parameters of connected devices.



Simple, small, new standard

Simple

INVERTER

# INVERTER FR-D700



- Easy use and time saving built-in as standard
- Easy maintenance
- Compact and space saving



**FR-D74□-□K**

Capacity: 0.4 kW to 15 kW



**FR-D72□-□K**

Capacity: 0.1 kW to 15 kW

For the details of the INVERTER FR-D700 Series, please refer to the catalog on the right.

(L(NA)06055ENG)



## Spring clamp terminal\* (control circuit terminal)

### ■ Easy wiring

Wiring is completed only by inserting wires treated with blade terminal. Capable of wiring without a blade terminal.

\*: Main circuit terminal is screw terminal.

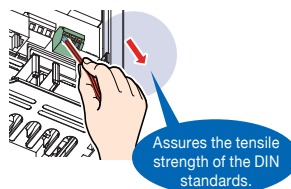
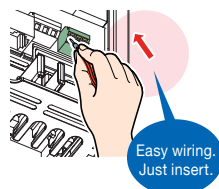

### ■ Highly reliable

Spring structure in terminal contact section inside prevents contact fault by vibration.

### ■ Maintenance is unnecessary

Screw retightening is unnecessary.

## Side by side installation saves space

Space can be saved by side by side no clearance installation\*. An optional DIN rail attachment (FR-UDA□□) can be attached.

\*: Use the inverter at the surrounding air temperature of 40°C or less.



## Easily replaceable compact body

Installation size is the same as that of the FR-S500 Series, the smallest model of the Mitsubishi inverter.



FR-D740-0.4K

FR-S540E-0.4K



Simple

PLC

The next level of industry



## MELSEC iQ-F series

- Outstanding performance
- Intuitive programming environment
- Superior drive control



For the details of the MELSEC iQ-F Series, please refer to the catalog on the left.  
(HIME-L081)



**FX5U**

32 to 256 control points\*  
Terminal block type



**FX5UC**

32 to 256 control points\*  
Connector type

\*: Control points up to 512 input/output points, including remote input/output.

### Built-in positioning

#### ■ Positioning capable of 20 $\mu$ s high-speed start

FX5U/FX5UC features powerful positioning functionality with 8 ch high-speed pulse input and 4-axis pulse output. Positioning operations including interrupt, variable speed, and simple interpolation can easily be set up in tables and executed.

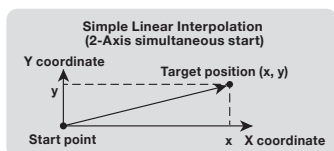
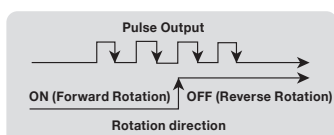

### Simple motion module

#### ■ Positioning control with SSCNETIII/H



FX5-40SSC-S

FX5-40SSC-S is equipped with a 4-axis positioning function compatible with SSCNETIII/H. By combining linear interpolation, 2-axis circular interpolation and continuous trajectory control in the program set with a table, a smooth trajectory can be easily drawn.

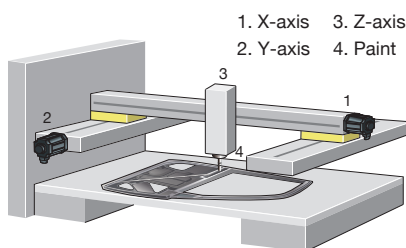

### Advanced motion control

#### ■ Making simple motion with compactly packed extra functions

By starting with parameter settings and the sequence program, the simple motion modules can realize a variety of motion control including positioning control, advanced synchronous control, cam control and speed-torque control.

- Use synchronous control and cam control to build a system perfect for your equipment.
- Register up to 64 types of cam patterns to respond to many kinds of control needs.
- Perform continuous operation without stopping the workpiece operation.

Reliable basic performance,  
advanced ease-of-use

Simple

SERVO

MITSUBISHI SERVO AMPLIFIERS & MOTORS

# MELSERVO

- High-precision tuning
- High functions for various applications
- Eco-friendly performance



SSCNETIII/H  
SERVO SYSTEM CONTROLLER NETWORK



**MR-JE-A**

General-purpose interface  
compatible servo amplifier



**MR-JE-B**

SSCNETIII/H compatible  
servo amplifier



**HG-KN Series**

Small capacity, low inertia  
Capacity: 100 W to 750 W



**HG-SN Series**

Medium capacity, medium inertia  
Capacity: 0.5 kW to 3 kW

For the details of the  
MELSERVO Series,  
please refer to the  
catalog on the right.  
(L)(NA)03086ENG)



## Easy to use

### ■ Advanced one-touch tuning

With just a single touch, you can complete servo adjustment. Vibration suppression, robust filter are automatically adjusted.

### ■ Large capacity drive recorder

The servo data before and after the alarm occurrence is stored in non-volatile memory and helps you quickly analyze the cause of the alarm.

### ■ Absolute position detection system

Absolute position detection system can be easily configured with MR-JE-B servo amplifier.

Adjust the servo gains just by pressing the buttons on the front of the servo amplifier.

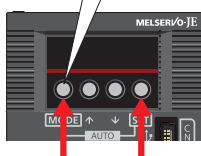

## High performance

### ■ SSCNETIII/H

MR-JE-B is compatible with 150 Mbps full duplex high-speed optical network SSCNETIII/H, achieving high-response system.

### ■ Fast and accurate

The dedicated engine enables speed frequency response of 2.0 kHz, shortening the tact time.

### ■ High-resolution encoder

The servo motor is equipped with 131,072 pulses/rev (17-bit) high-resolution encoder, achieving high accuracy.

[Settling time comparison with the prior model]

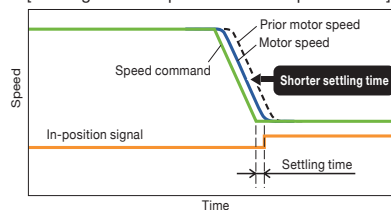

## Enhanced integration with drive control

### ■ Built-in positioning function

AC servos with the built-in positioning function can be connected to GOT for positioning and adjustment.\*

\*: JE-A only



Various setting screens

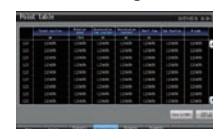

Point table setting



Tuning

### Mitsubishi Industrial Robot MELFA

# MELFA F Series

Vertical, multiple-joint type/Horizontal, multiple-joint type

- Compact body and slim arm design, allowing operating area to be expanded and load capacity increased.
- The fastest in its class using high performance motors and unique driver control technology.
- Improved flexibility for robot layout design considerations.
- Optimal motor control tuning set automatically based on operating position, posture, and load conditions.



For the details of the MELFA F Series, please refer to the catalog above.  
(L(NA)09067ENG)



### Mitsubishi Magnetic Contactor

# MS-T Series

- 10A frame model is over 16% smaller with a width of just 36mm!!
- New integrated terminal covers.
- Reduce your coil inventory by up to 50%.
- Be certified to the highest international levels while work is ongoing to gain other country.



For the details of the MS-T Series, please refer to the catalog above.  
(L(NA)02030ENG)



### Mitsubishi Molded-Case Circuit Breakers

# MX Series

- Uniform height of the full range. <68mm>
- Easy to install cassette-type internal accessories for 160AF and 250AF.
- For OEM market, suitable for mechanical devices and design of control panel.
- Compliance with GB, IEC, EN standards.



For the details of the molded-case circuit breakers, please refer to the catalog above.





## FA Integrated Engineering Software

# MELSOFT iQ Works

MELSOFT iQ Works is an integrated software suite consisting of GX Works3, MT Works2, GT Works3, RT Toolbox2 mini and FR Configurator2, which are programming software for each respective product. Integration is further enhanced with MELSOFT Navigator as the central system configuration incorporating an easy-to-use, graphical user interface with additional project-sharing features such as system labels and parameters. The advantages of this powerful integrated software suite are that system design is made much easier with a substantial reduction in repetitious tasks, cutting down on errors while helping to reduce the overall TCO.

### System Management Software

## MELSOFT Navigator

System level graphic-based configuration tool that simplifies the system design by providing a visual representation of the system. System management features such as system-wide parameterization, labels and block reading of project data are also included. (GOT SIMPLE, FR-D700 are not supported.)



### GOT Screen Design Software

## MELSOFT GT Works3

This integrated software is used to create professional screen designs for GOTs. Developed with the concepts of "Simplicity", "Sleekness", and "User-friendliness" in mind, this is a powerful tool that pushes boundaries and delivers endless design possibilities.

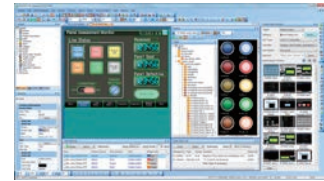

### Programmable Controller Engineering Software

## MELSOFT GX Works3

GX Works3 is the latest generation of programming and maintenance software offered by Mitsubishi Electric specifically designed for the MELSEC iQ-R and iQ-F Series control system. It includes many new features such as graphic-based system configuration, integrated motion control setup, multiple language support, providing an intuitive engineering environment solution.

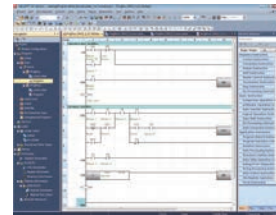

### Motion Controller Engineering Software

## MELSOFT MT Works2

This motion control design and maintenance software includes intuitive graphic-based programming together with a digital oscilloscope simulator.



### Robot Engineering Software

## MELSOFT RT ToolBox2 mini

This robot setup software supports various steps from programming, to commissioning, evaluation, and maintenance. In addition, improved preventative maintenance is realized through the use of an integrated 3D robot simulator.



### Inverter Setup Software

## MELSOFT FR Configurator2

This software simplifies the setup and maintenance of AC Inverters. Parameters can be registered easily and distributed to multiple inverters when replacing, and activation of the PLC function all from one setup screen. (FR-D700 is not supported.)

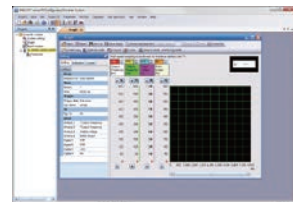

### Servo Setup Software

## MELSOFT MR Configurator2

Tuning, monitor display, diagnosis, reading/writing parameters, and test operations are easily performed on a personal computer. This start-up support tool achieves a stable machine system, optimum control, and short setup time.

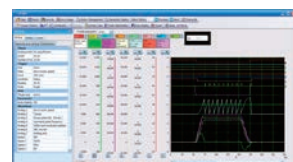

# Mitsubishi Graphic Operation Terminal

## GOT SIMPLE Series Solution Catalog

# Global Partner. Local Friend

### American Offices

<b>USA</b> <b>Mitsubishi Electric Automation, Inc.</b> 500 Corporate Woods Parkway, Vernon Hills, IL 60061, U.S.A. Tel: +1-847-478-2100	<b>Mexico</b> <b>Mitsubishi Electric Automation, Inc.</b> <b>Mexico Branch</b> Mariano Escobedo #69, Col. Zona Industrial, Tlalnepantla Edo. Mexico, C.P.54030 Tel: +52-55-3067-7511	<b>Brazil</b> <b>Mitsubishi Electric do Brasil Comercio e Servicos Ltda.</b> Rua Jussara, 1750- Bloco B Anexo, Jardim Santa Cecilia, CEP 06465-070, Barueri - SP, Brasil Tel: +55-11-4689-3000
--	---	--

### Asia-Pacific Offices

<b>China</b> <b>Mitsubishi Electric Automation (China) Ltd.</b> No.1386 Hongqiao Road, Mitsubishi Electric Automation Center, Shanghai, China Tel: +86-21-2322-3030	<b>Taiwan</b> <b>SETSUYO ENTERPRISE CO., LTD.</b> 6F, No.105, Wugong 3rd Road, Wugu District, New Taipei City 24889, Taiwan Tel: +886-2-2299-2499	<b>Korea</b> <b>Mitsubishi Electric Automation Korea Co., Ltd.</b> 7F-9F, Gangseo Hangang Xi-tower A, 401, Yangcheon-ro, Gangseo-Gu, Seoul 07528, Korea Tel: +82-2-3660-9530
<b>Singapore</b> <b>Mitsubishi Electric Asia Pte. Ltd.</b> 307 Alexandra Road, Mitsubishi Electric Building, Singapore 159943 Tel: +65-6473-2308	<b>Thailand</b> <b>Mitsubishi Electric Factory Automation (Thailand) Co., Ltd.</b> 12th Floor, SV.City Building, Office Tower 1, No. 896/19 and 20 Rama 3 Road, Kwaeng Bangpongpan, Khet Yannawa, Bangkok 10120, Thailand Tel: +66-2682-6522 to 31	<b>Indonesia</b> <b>PT. Mitsubishi Electric Indonesia</b> Gedung Jaya 11th Floor, JL. MH. Thamrin No.12, Jakarta Pusat 10340, Indonesia Tel: +62-21-3192-6461
<b>Vietnam</b> <b>Mitsubishi Electric Vietnam Co., LTD.</b> <b>Ho Chi Minh Head Office</b> Unit 01-04, 10th Floor, Vincorm Center, 72 Le Thanh Ton Street, District 1, Ho Chi Minh City, Vietnam Tel: +84-8-3910-5945	<b>India</b> <b>Mitsubishi Electric India Pvt. Ltd.</b> <b>Pune Branch</b> Emerald House, EL -3, J Block, M.I.D.C., Bhosari, Pune - 411026, Maharashtra, India Tel: +91-20-2710-2000	<b>Australia</b> <b>Mitsubishi Electric Australia Pty. Ltd.</b> 348 Victoria Road, P.O. Box 11, Rydalmere, N.S.W. 2116, Australia Tel: +61-2-9684-7777

### European Offices

<b>Germany</b> <b>Mitsubishi Electric Europe B.V.</b> <b>German Branch</b> Gothaer Strasse 8, 40880 Ratingen, Germany Tel: +49-2102-486-0	<b>UK</b> <b>Mitsubishi Electric Europe B.V.</b> <b>UK Branch</b> Travellers Lane, Hatfield, Hertfordshire, AL10 8XB, U.K. Tel: +44-1707-28-8780	<b>Italy</b> <b>Mitsubishi Electric Europe B.V.</b> <b>Italian Branch</b> Centro Direzionale Colleoni - Palazzo Sirio, Viale Colleoni 7, 20864 Agrate Brianza (Milano), Italy Tel: +39-039-60531
<b>Spain</b> <b>Mitsubishi Electric Europe B.V.</b> <b>Spanish Branch</b> Carretera de Rubi 76-80-Apdo.420, 08190 Sant Cugat del Valles (Barcelona), Spain Tel: +34-935-65-3131	<b>France</b> <b>Mitsubishi Electric Europe B.V.</b> <b>French Branch</b> 25, Boulevard des Bouvets, 92741 Nanterre Cedex, France Tel: +33-1-55-68-55-68	<b>Czech</b> <b>Mitsubishi Electric Europe B.V.</b> <b>Czech Branch</b> Avenir Business Park, Radlicka 751/113e, 158 00 Praha 5, Czech Republic Tel: +420-251-551-470
<b>Turkey</b> <b>Mitsubishi Electric Turkey A.S.</b> <b>Umraniye Branch</b> Serifali Mahallesi Nutuk Sokak No:5, TR-34775 Umraniye / Istanbul, Turkey Tel: +90-216-526-3990	<b>Poland</b> <b>Mitsubishi Electric Europe B.V.</b> <b>Polish Branch</b> ul. Krakowska 50, 32-083 Balice, Poland Tel: +48-12-347-65-00	<b>Russia</b> <b>Mitsubishi Electric (Russia) LLC</b> <b>St. Petersburg Branch</b> Piskarevsky pr. 2, bld 2, lit "Sch", BC "Benua", office 720; RU-195027 St. Petersburg, Russia Tel: +7-812-633-3497
<b>South Africa</b> <b>Adroit Technologies</b> 20 Waterford Office Park, 189 Witkoppen Road, Fourways, Johannesburg, South Africa Tel: +27-11-658-8100		

The actual color may differ slightly from the pictures in this catalog.  
The actual display may differ from what are shown on GOT screen images.

 **Precautions for safe use**

To use the products given in this document, always read the related manuals before starting to use them.

**Trademarks and registered trademarks**

All products and company names used herein are either trademarks or registered trademarks of their respective owners.

The release date varies depending on the product and your region. For details, please contact your local sales office.

**MITSUBISHI ELECTRIC CORPORATION**  
HEAD OFFICE: TOKYO BLDG., 2-7-3, MARUNOUCHI, CHIYODA-KU, TOKYO 100-8310, JAPAN  
NAGOYA WORKS: 1-14, YADA-MINAMI 5, HIGASHI-KU, NAGOYA, JAPAN